

Sold

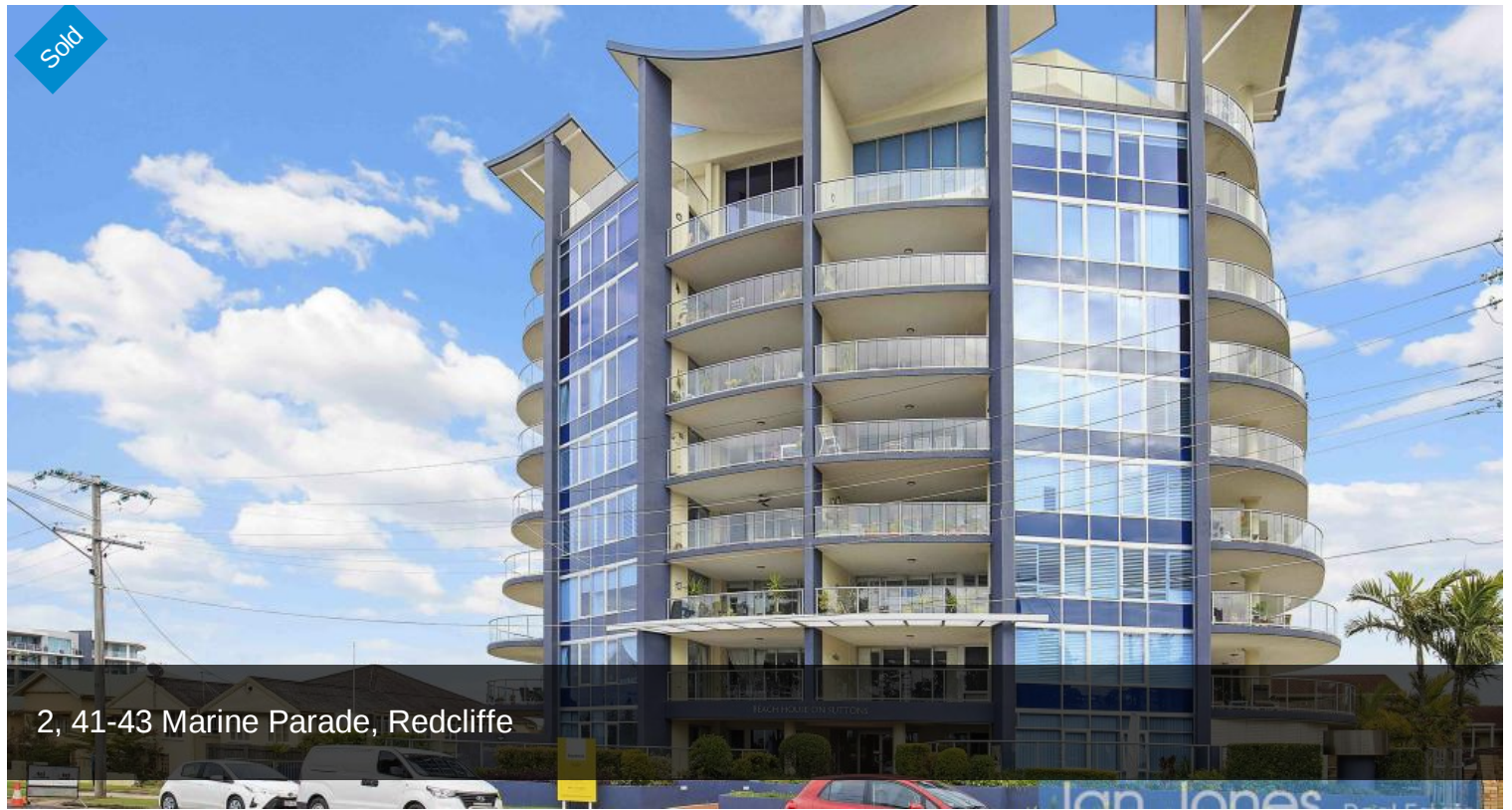

2, 41-43 Marine Parade, Redcliffe





Ground Floor – Massive Courtyard – Beachside Location

Located on the ground floor of the very popular Beach House On Suttons this one is a super rare find. The property is large (235sqm) and features high ceilings, heaps of natural light and a massive courtyard. The complex and the property is well maintained and the location is perfect with Suttons Beach, kilometers of walking tracks, shops, medical facilities, markets and public transport all on the door step.

The home features:

- Ducted air conditioning
- Large open plan lounge, dining, kitchen. The area flows to the outdoors.
- Modern kitchen with stone benches, large pantry, dishwasher, wall oven, gas cooktop, rangehood, and a breakfast bar

 2  2  2 

Price SOLD for
\$680,000

Property Type Residential

Property ID 1623

Floor Area 235 m2

Agent Details

Rachele Jones - 0432 834
733

Office Details

Clontarf
48 Hornibrook Esplanade
Clontarf QLD 4019 Australia
07 3283 6737

- 2 spacious bedrooms with built in robes, direct access to the courtyard, and water glimpses. The master bedroom has a walk-in robe and well-appointed ensuite with a spa bath and walk in shower.
- Study or 2nd living area
- Guest bathroom and laundry is combined and has a shower over the bathtub. The toilet is separate
- Huge courtyard. This space is massive and prefect for those who like outdoor living. There is ample room for the outdoor furniture and pot plants and the area is private.
- Ample storage throughout
- 2 car tandem carpark with storage locker

Beach House On Suttons has a high percentage of owner occupiers and a very reasonable body corporate. There is a lovely inground pool and big covered entertainment at the rear of the ground as a common BBQ area. There is also a secure basement carpark, secure entry, an intercom system, library and gym.

Whether you are looking for your own beachside escape, to holiday all year around or a great investment this one is the one your have been waiting for.

All information contained herein is gathered from sources we believe to be reliable. However we cannot guarantee its accuracy and interested persons should rely on their own enquiries.

The above information provided has been furnished to us by the vendor/s. We have not verified whether or not that information is accurate and do not have any belief in one way or the other in its accuracy. We do not accept any responsibility to any person for its accuracy and do no more than pass it on. All interested parties should make and rely upon their own inquiries in order to determine whether or not this information is in fact accurate.

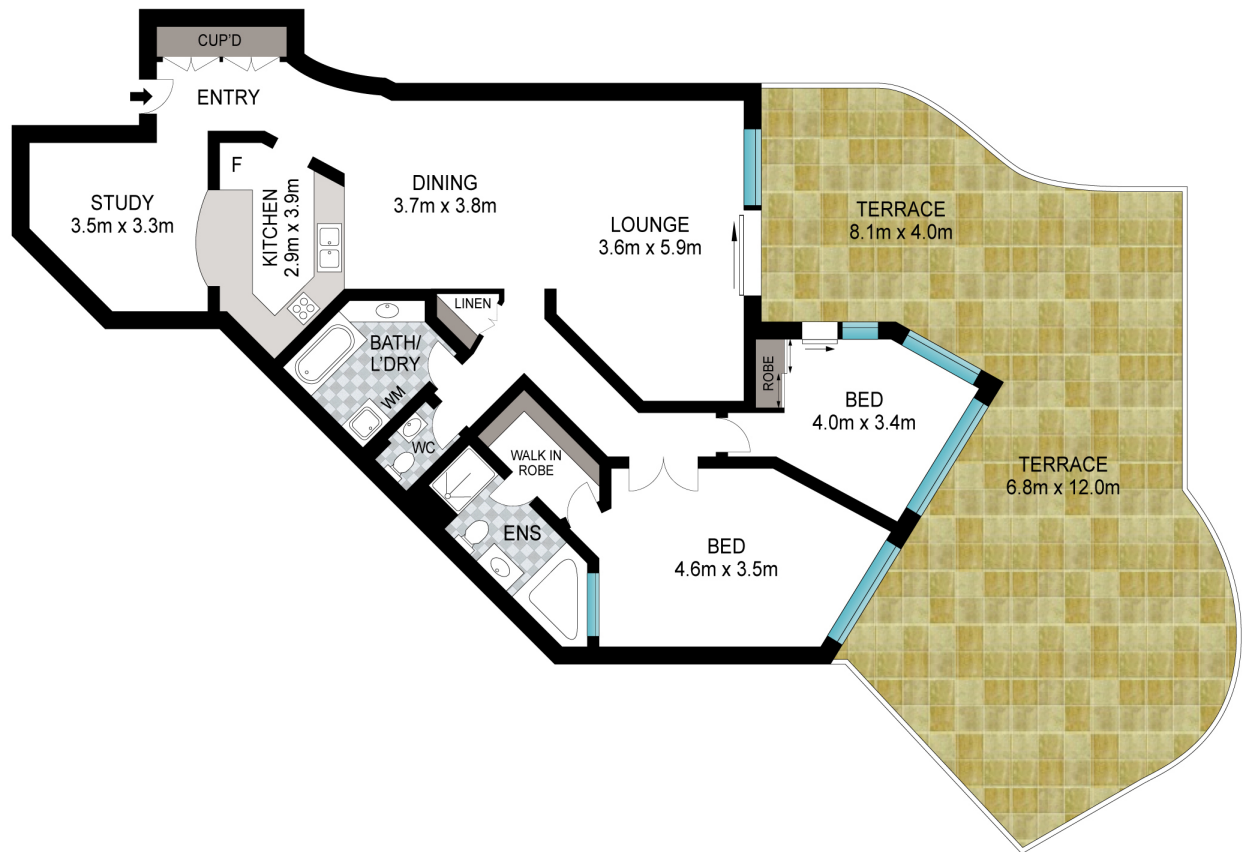

Scale in metres. Indicative only. Dimensions are approximate. All information contained herein is gathered from sources we believe to be reliable. However, we cannot guarantee its accuracy and interested persons should rely on their own enquiries.

INT: 116 m²
EXT: 75 m²

2/41-43 Marine Parade, Redcliffe